

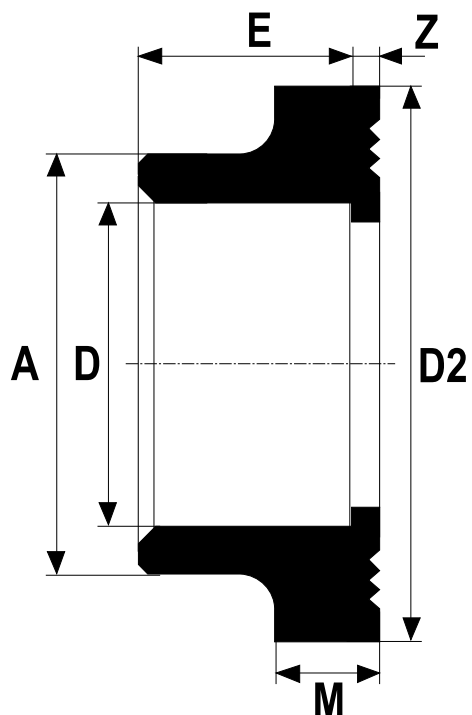

| Referencia | Medidas | Carac. | u./caja |
|------------|---------|--------|---------|
| 081102     | 25      | -      | 75      |
| 081103     | 32      | -      | 50      |
| 081104     | 40      | -      | 50      |
| 081105     | 50      | -      | 30      |
| 081106     | 63      | -      | 16      |
| 081107     | 90      | -      | 5       |
| 081108     | 110     | -      | 5       |
| 081173     | 75      | -      | 10      |
| 081183     | 160     | -      | 1       |
| 081298     | 125     | -      | 2       |

Portabrida hembra.



### Cotas

| Referencia | A     | D   | D2    | Dn  | E    | M    | Z |
|------------|-------|-----|-------|-----|------|------|---|
| 081102     | 33    | 25  | 41    | 20  | 20   | 7    | 3 |
| 081103     | 41    | 32  | 50    | 25  | 23   | 7    | 3 |
| 081104     | 50    | 40  | 61    | 32  | 27   | 8    | 3 |
| 081105     | 61    | 50  | 73    | 40  | 32   | 8    | 3 |
| 081106     | 76    | 63  | 90    | 50  | 38.5 | 9    | 3 |
| 081107     | 108   | 90  | 125   | 80  | 51.5 | 11   | 5 |
| 081108     | 130.5 | 110 | 150   | 100 | 62   | 11.5 | 5 |
| 081173     | 90    | 75  | 106   | 65  | 44   | 10   | 3 |
| 081183     | 187   | 160 | 211.4 | 150 | 86   | 16   | 6 |

## Documentación



## Tarifas



## Certificados

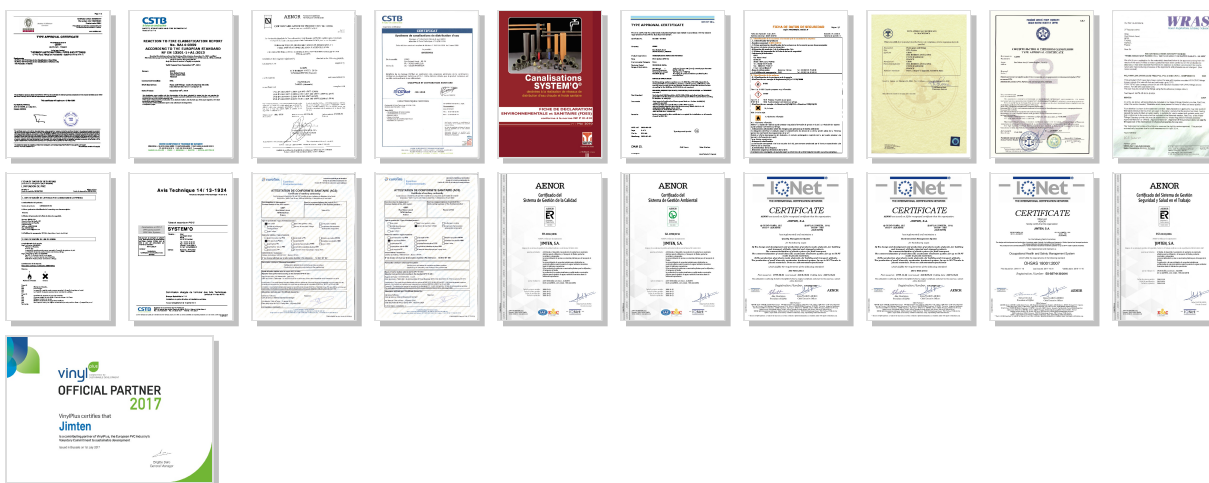

Para más información visite la dirección <https://www.jimten.com/es/producto/3851/portabrida-hembra-cpvc/>

